

Technical specification

Mounting torque:	15 ... 20 Nm	
Operating temperature:	-25°C ... +85°C	
Media temperature:	ECT:	-25°C ... +125°C
	ECT 400bar/5000psi:	-10°C ... +125°C
	ECTN:	-25°C ... +85°C
	ECTN 400bar/5000psi:	-10°C ... +85°C

Type label description

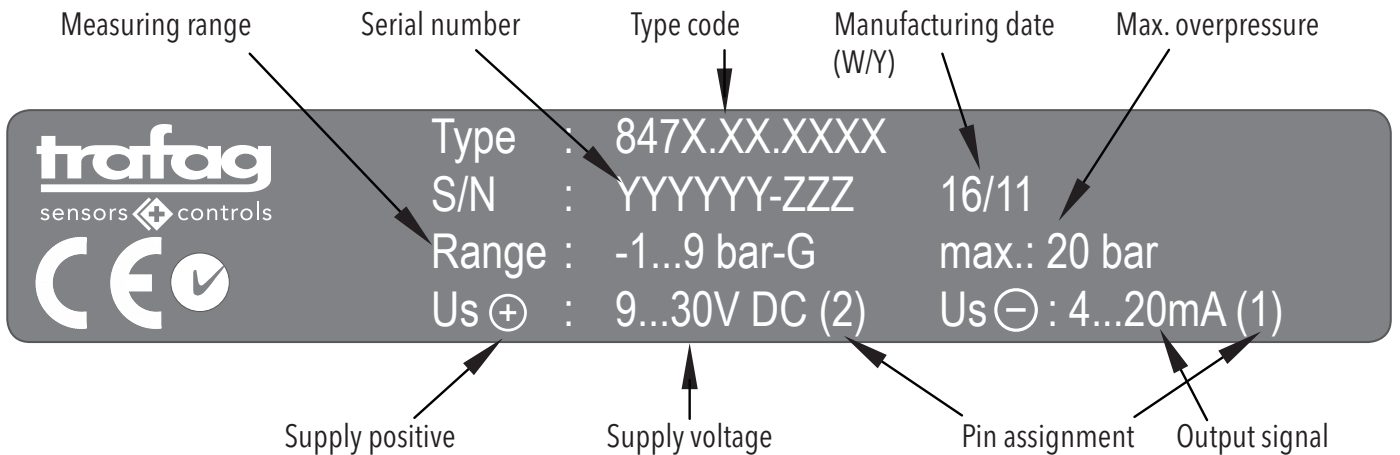

H73324k Trafag AG 01/2016

Electrical connections

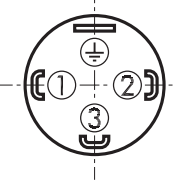
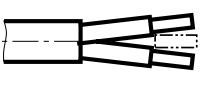
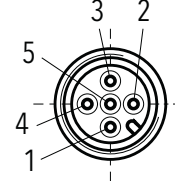
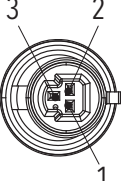
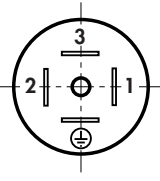
Ingress Protection	IP65 ²⁾	IP67 / IP68 max.3m	IP67 ²⁾	IP67 ²⁾	IP65
Designation	EN175301-803A (DIN43650-A)	Cable (PVC) (PUR) 4 x 0.25mm ²	M12x1 5-pol.	Packard Metri Pack 3-pol.	Industrial Standard contact distance 9.4 mm
Type code	847X.XX.XXXX 05	847X.XX.XXXX 22/68	847X.XX.XXXX 35	847X.XX.XXXX 51	847X.XX.XXXX 01
Pin configuration					

Output

4 ... 20 mA
0 ... 5 VDC
1 ... 6 VDC
0 ... 10 VDC
0.5 ... 4.5 VDC

Load resistance

(U _{SUPPLY} -9V)/ 20mA
> 2.5 kΩ
> 5.0 kΩ
> 5.0 kΩ
> 5.0 kΩ

I_{SUPPLY}

<10 mA
<10 mA
<10 mA
<10 mA

U_{SUPPLY}

9 ... 30 VDC
10 ... 30 VDC
10 ... 30 VDC
15 ... 30 VDC
5 VDC ± 0.25 V

²⁾ Provided female connector is mounted according to instructions

Ventilation via cable end/connector. Shield in the device is not connected

Electrical connections

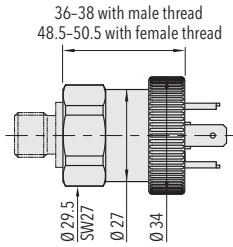

847X.XX.XXXX05XX.XX

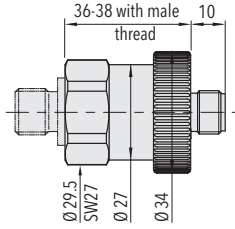

847X.XX.XXXX35XX.XX

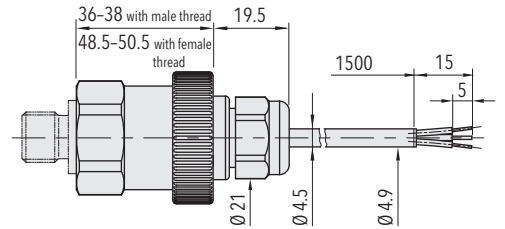

847X.XX.XXXX22XX.XX

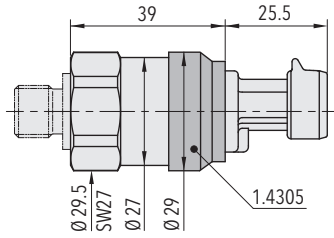

847X.XX.XXXX51XX.XX

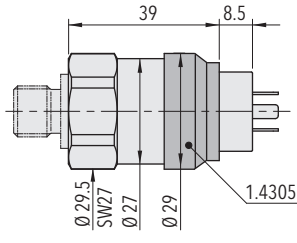

847X.XX.XXXX01XX.XX

Pressure connections

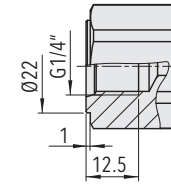

847X.XX.XX10XX...

Pressure connections

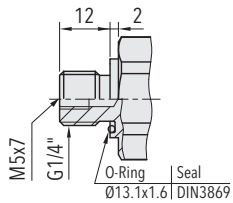

847X.XX.XX17XX...

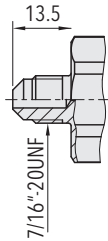

847X.XX.XX18XX...

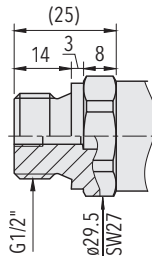

847X.XX.XX21XX...

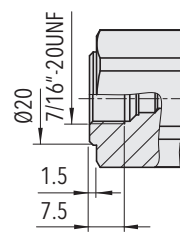

847X.XX.XX24XX...

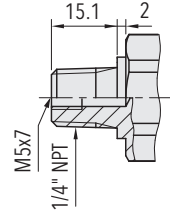

847X.XX.XX30XX...

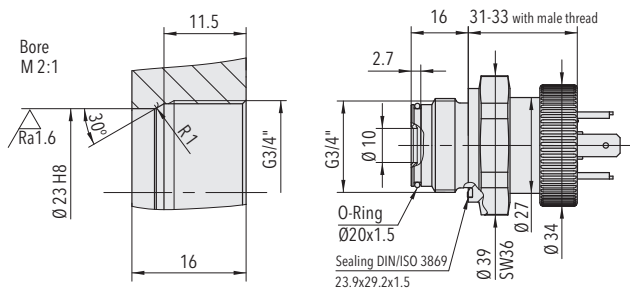

847X.XX.XX52XX...

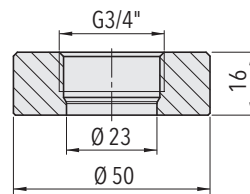

Welding flange for G3/4" frontal membrane (1.4301)
Ordering No. C27805

Connection of the measuring equipment

Current output

2-wires

single arrangement

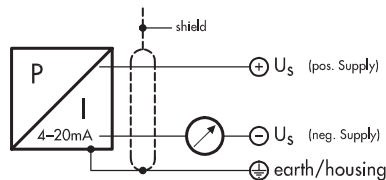

multiple arrangement

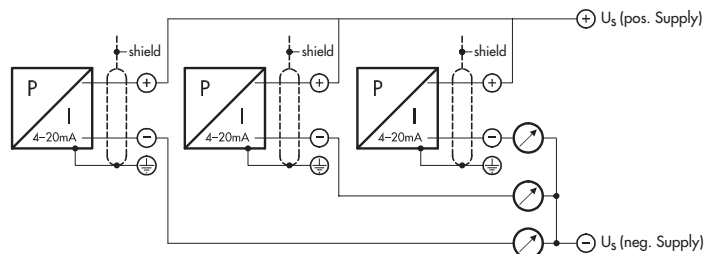

Voltage output

3-wires

single arrangement

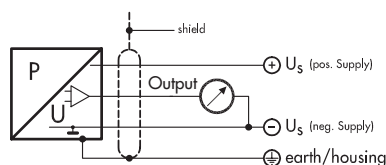

multiple arrangement

